

Ball & Pintle Hook Combination Safety Recall 20E-065

Inspection Instruction for Test 2 of 2 – Safety Pin Test

Revision Oct 21, 2020

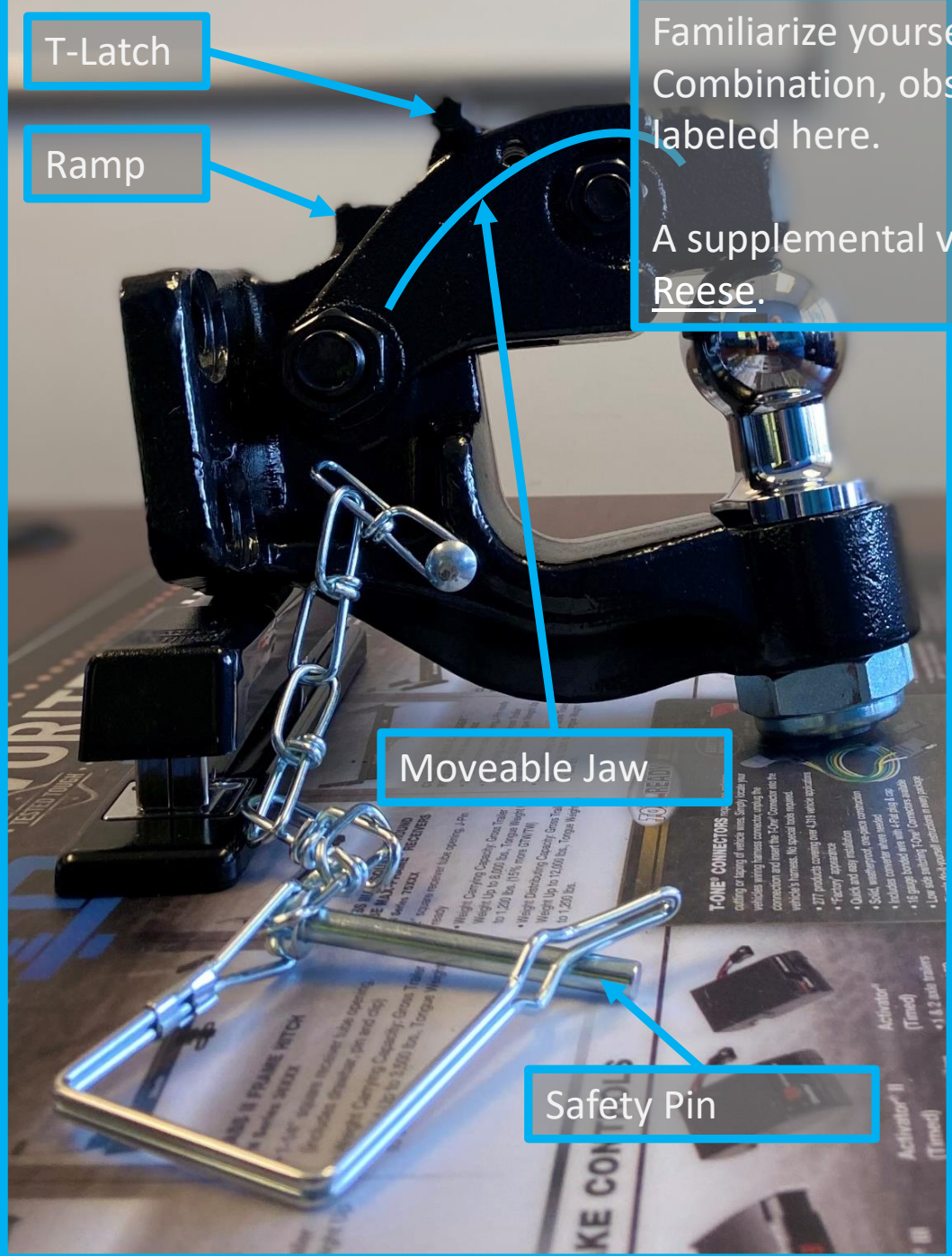

Familiarize yourself with the Ball & Pintle Hook Combination, observing the component names as labeled here.

A supplemental video is available at [Draw-Tite](#) or [Reese](#).

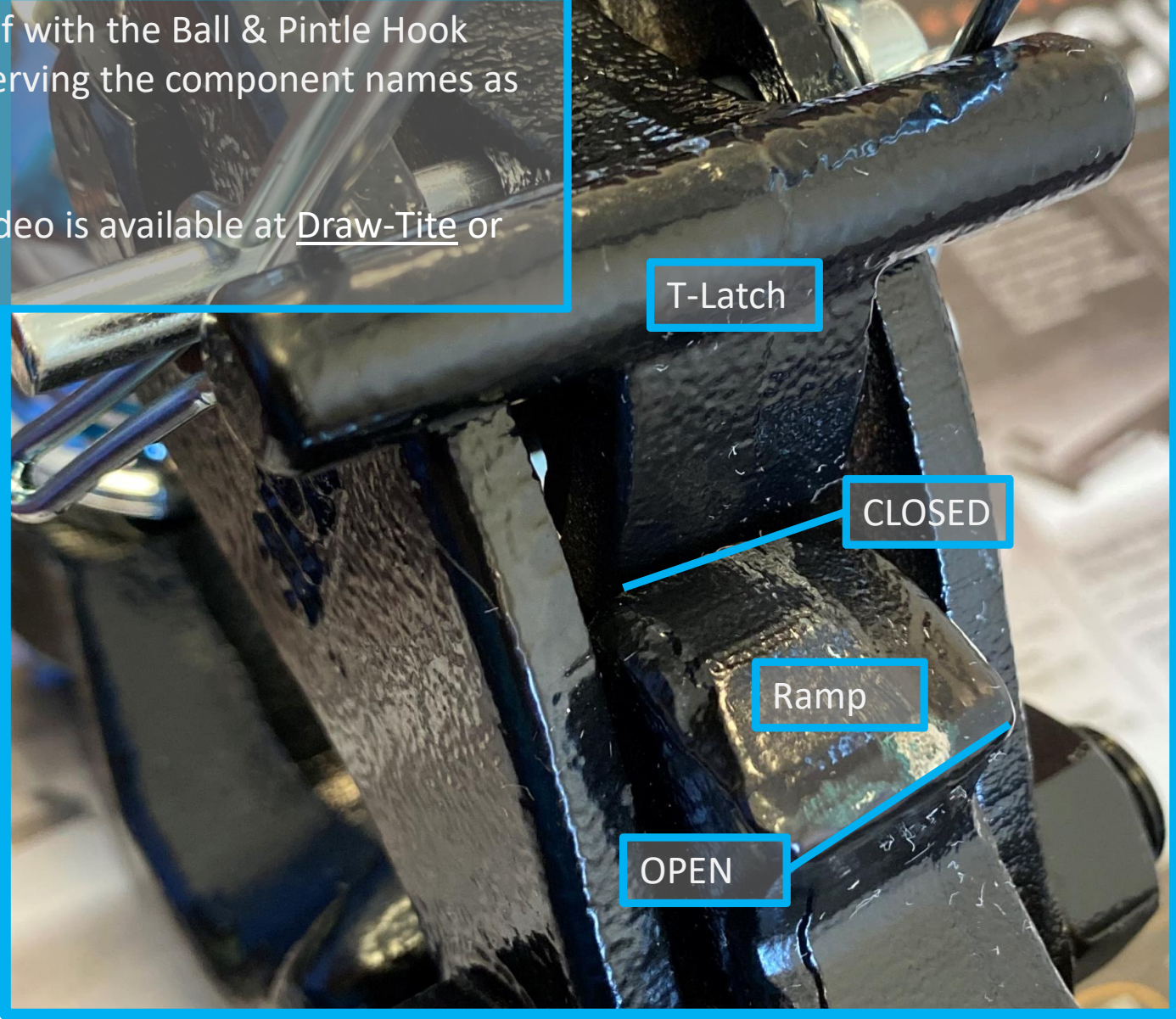



1. Move your Ball & Pintle to the fully open position & install the Safety Pin. The testing may also be completed on installed Ball & Pintle units.



2. Using moderate closure force, with only the palm of your hand, rotate the Moveable Jaw in the close direction. Do not use excessive force as it may damage or bend your Safety Pin.

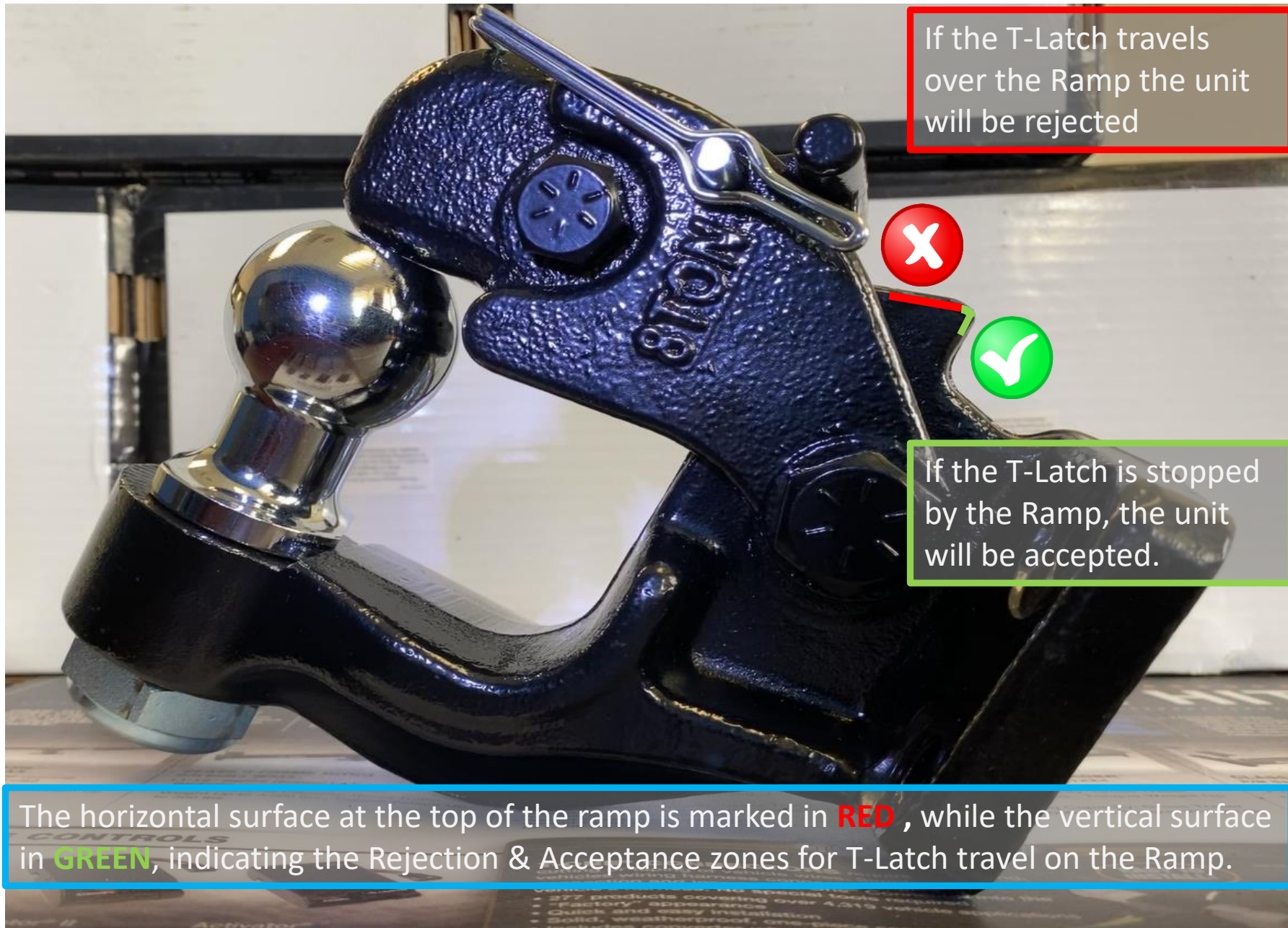

If the T-Latch travels over the Ramp the unit will be rejected



If the T-Latch is stopped by the Ramp, the unit will be accepted.

The horizontal surface at the top of the ramp is marked in **RED**, while the vertical surface in **GREEN**, indicating the Rejection & Acceptance zones for T-Latch travel on the Ramp.

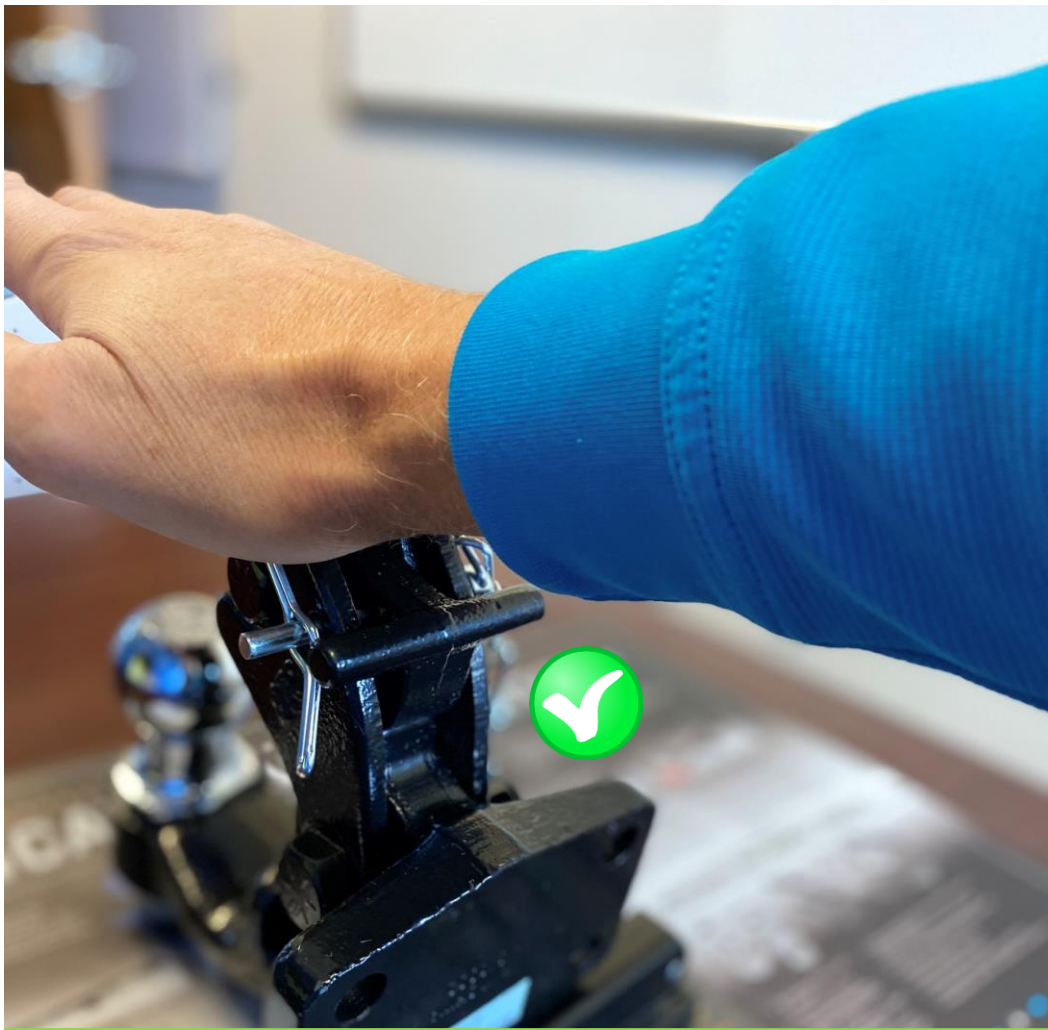

3. Check the position of your T-Latch; if it travels up, but NOT over the Ramp, the unit is not affected (is acceptable; no return is necessary). The Moveable Jaw should easily return to the fully open position. See supplemental Photo A on the next slide.

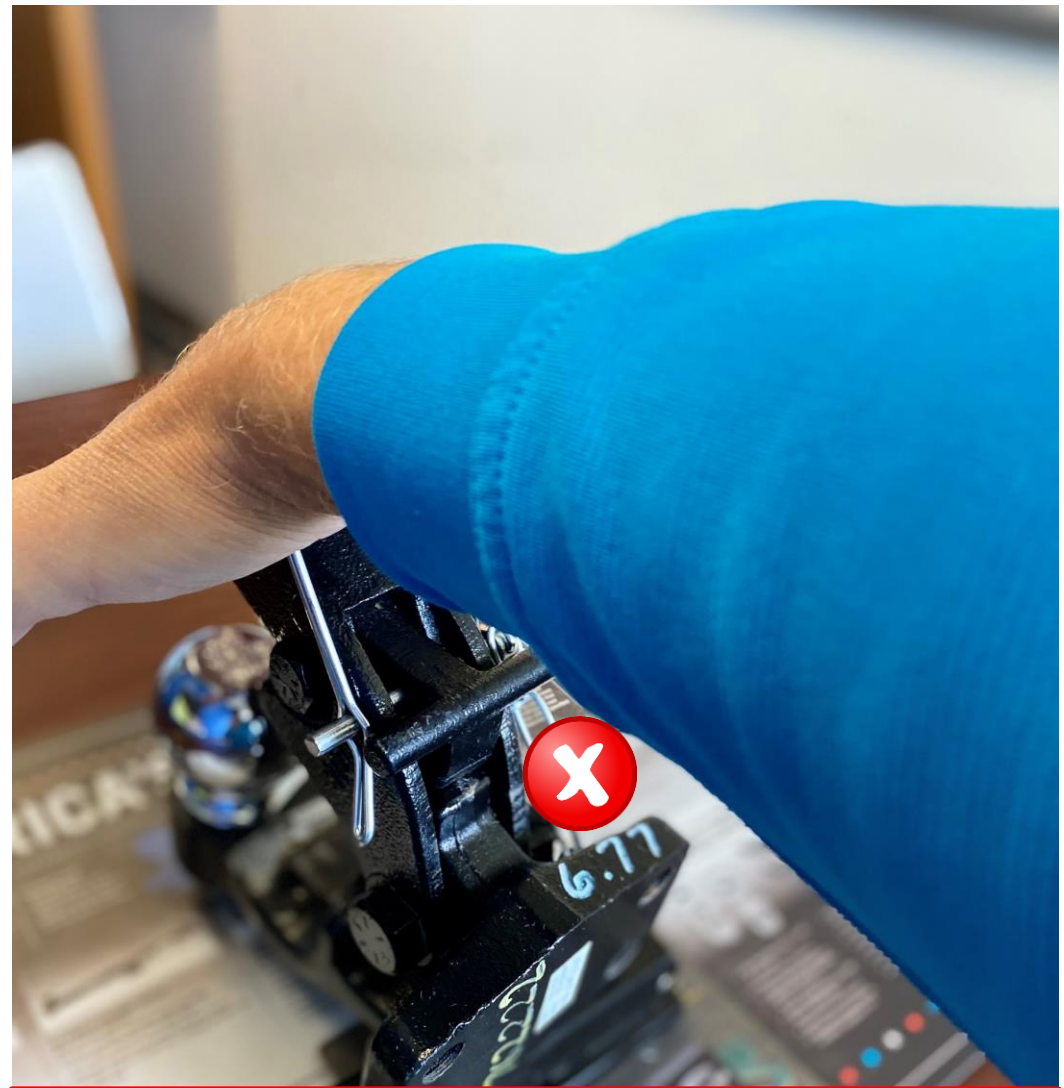

4. If the T-Latch travels up & over the Ramp, or “jams” at the top, the unit may have insufficient latch, and you should complete our Recall Registration at [Draw-Tite](#) or [Reese](#). See supplemental Photo R on the next slide.

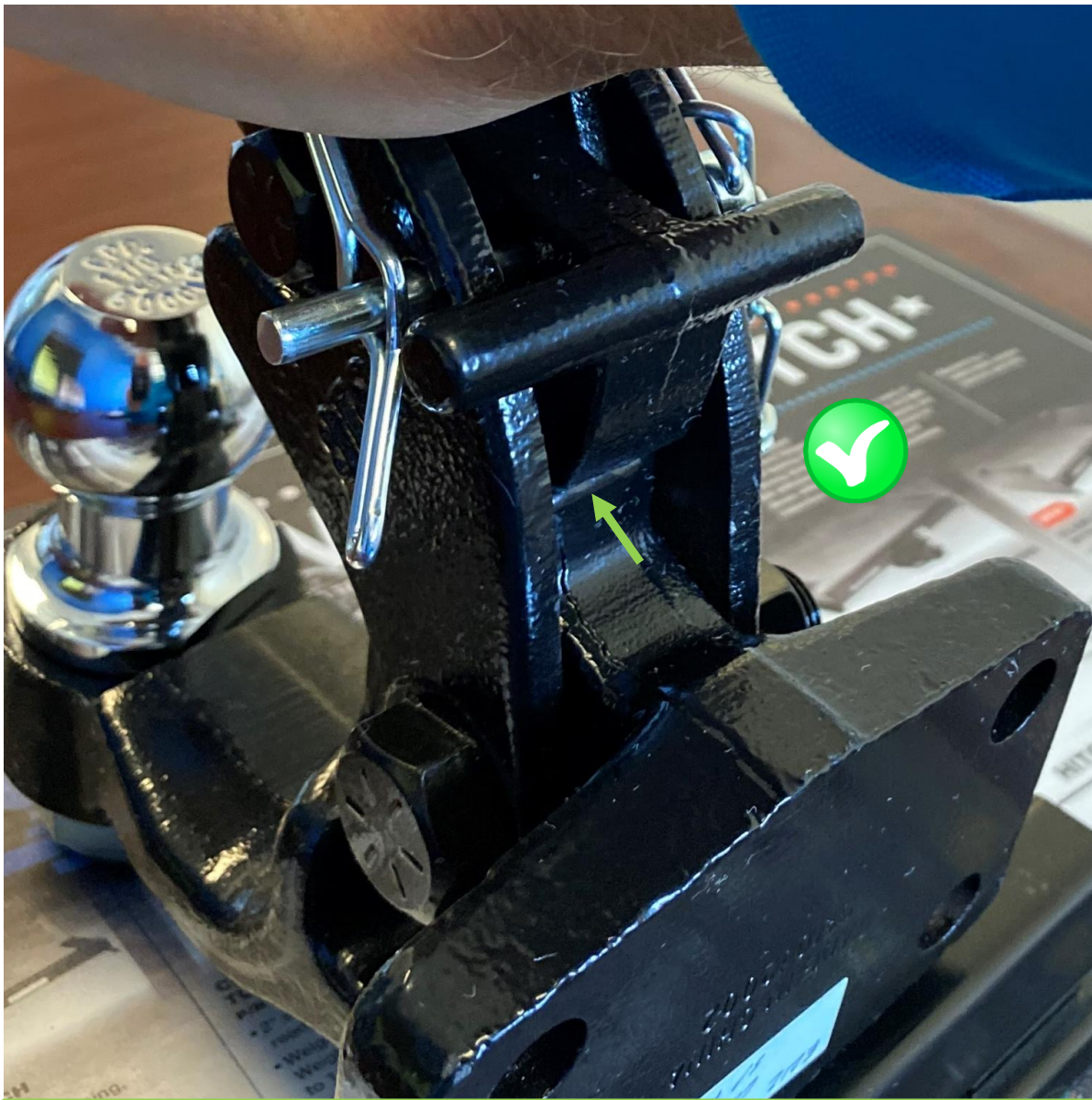

A. Supplemental photo of an Acceptable Ball & Pintle Hook Combination. Notice the position of the T-Latch has not traveled over onto the top of the Ramp.

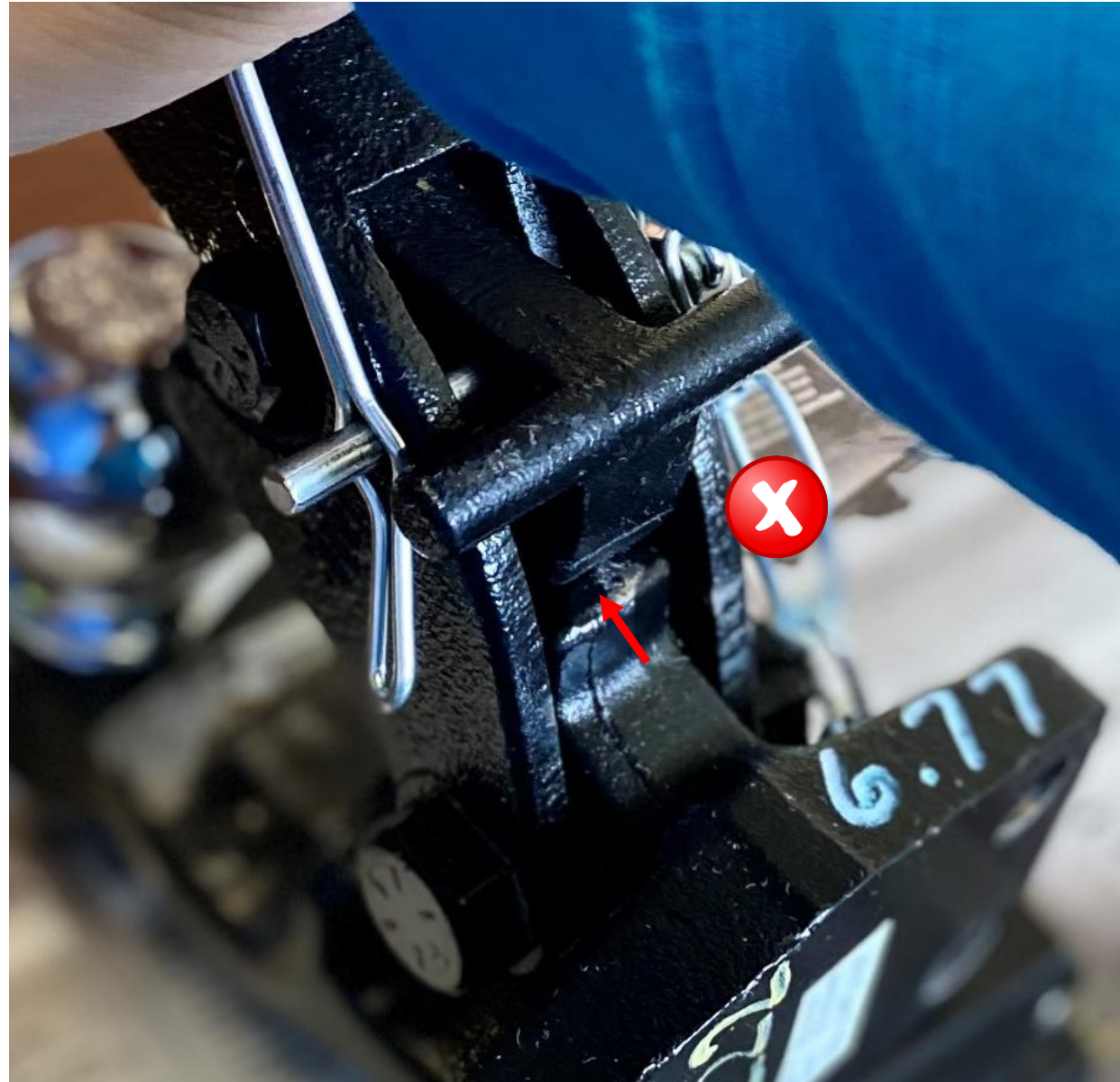

R. Supplemental photo of an Unacceptable Ball & Pintle Hook Combination. Notice the position of the T-Latch has traveled over onto the top of the Ramp.